

Measure E Plans and Status Report

October 28, 2014

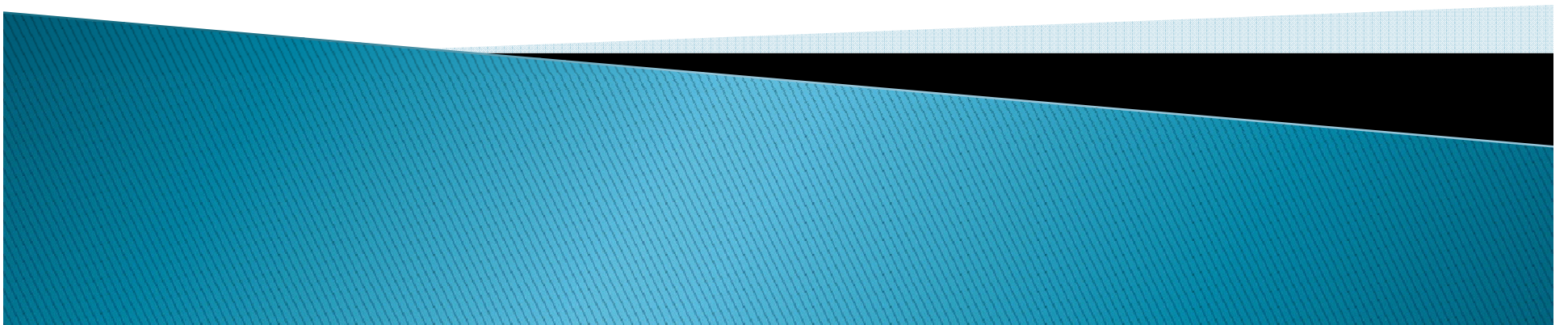

Measure E Project List

\$60,000,000 Bond Authorization

▶ Replace Portables–5 sites	\$38,359,297
▶ New Classroom Technology	10,000,000
▶ Renovate Newhall Auditorium	4,690,189
▶ Retire COP Debt	3,640,026
▶ New Tech Infrastructure	2,331,880
▶ Stevenson Ranch ADA, Restroom	584,434
▶ Science Labs	220,000
▶ Roof Replacement	292,422
▶ District wide projects	486,332
Total	\$60,604,580

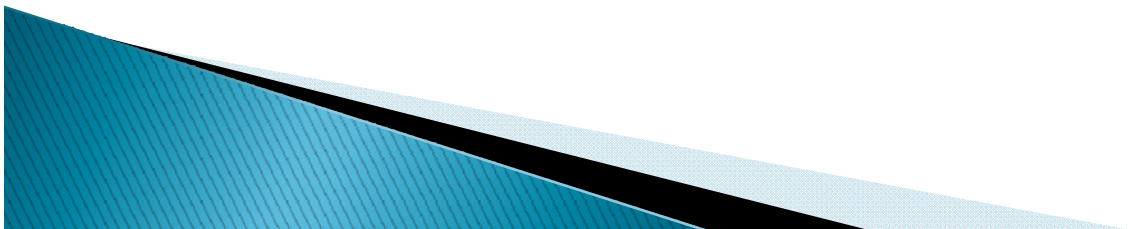



AUDITORIUM RENOVATION





Originally constructed in 1941 the Newhall Elementary School Auditorium exemplifies the Art-Deco architectural style popular for public works projects at this time.

TRANSFORMATION

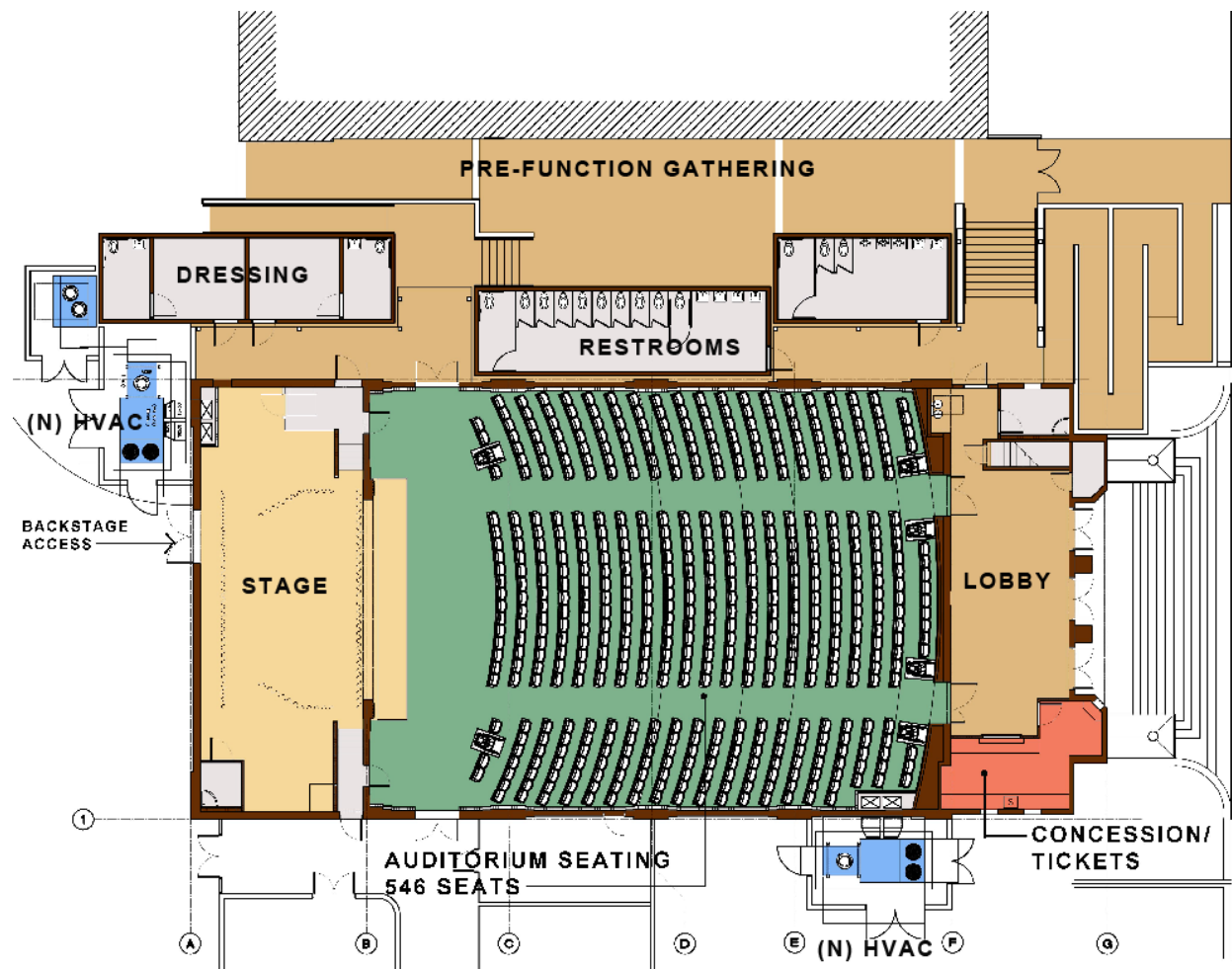

- STAGE EXPANSION
- NEW STAGE LIGHTING & AUDIO-VISUAL EQUIPMENT
- IMPROVED ACOUSTICS
- ACCESS COMPLIANCE IMPROVEMENTS (ADA)
- FIRE -LIFE SAFETY SYSTEMS
- NEW DRESSING ROOMS AND RESTROOMS
- PRE-FUNCTION AT EXTERIOR
- NEW CONCESSION AND TICKET AREA
- NEW SEATING FOR 546
- NEW HEATING AND COOLING SYSTEMS
- LOBBY RENOVATION

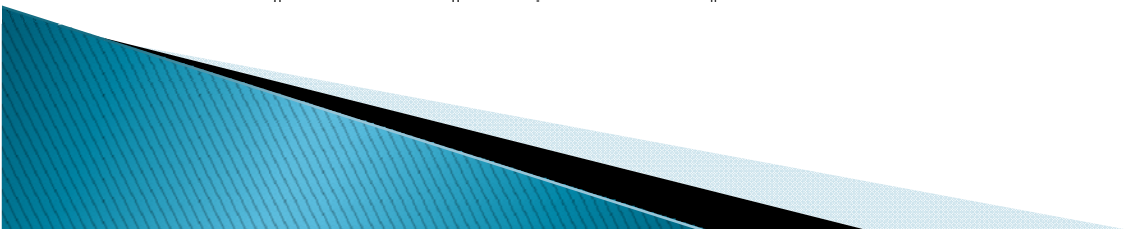

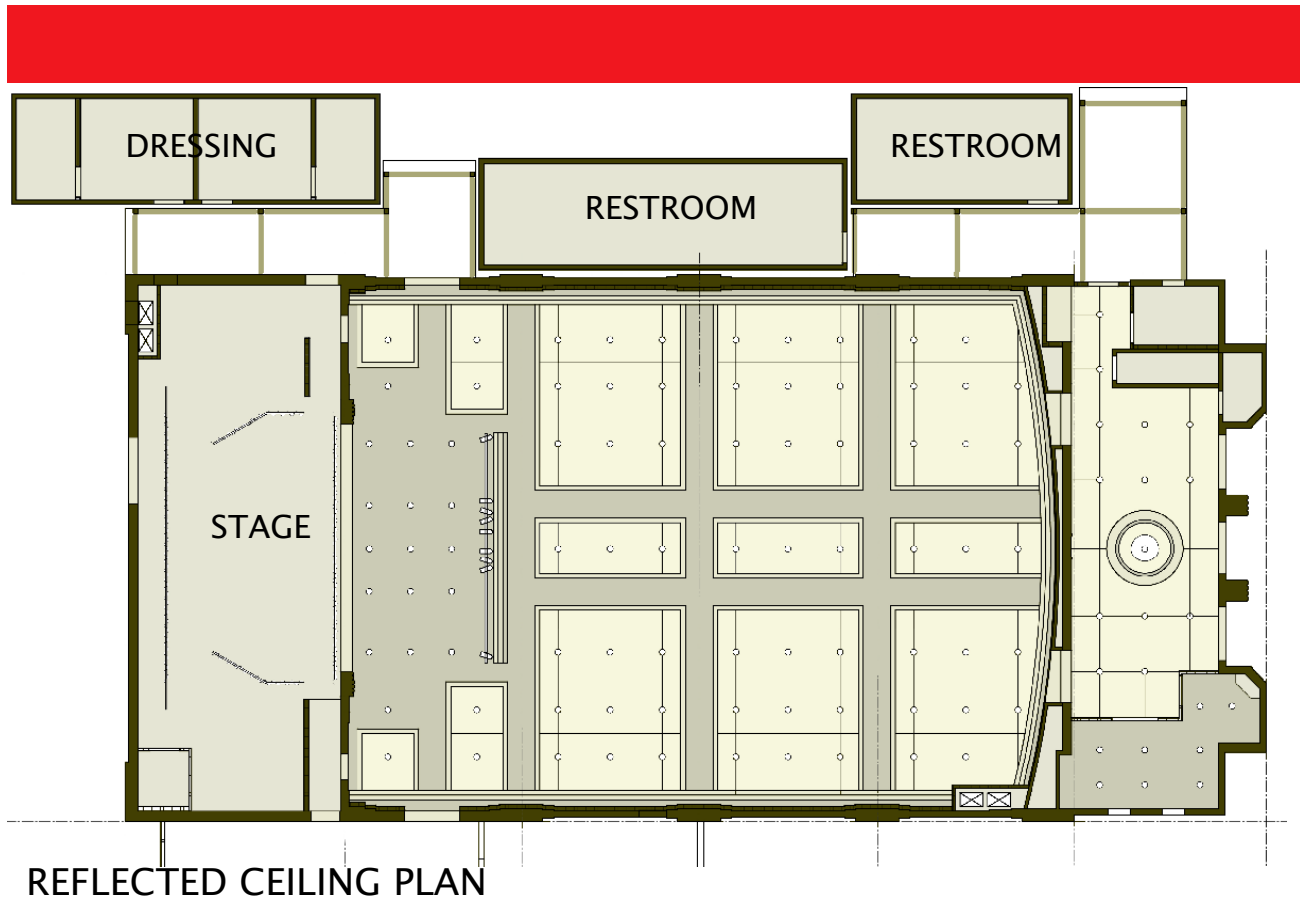

REFLECTED CEILING PLAN

Decorative geometry consistent with Art-Deco style of building.

High efficiency lighting (LED)

Acoustical materials



LOBBY DECORATIVE FIXTURE



ACOUSTICAL CEILING

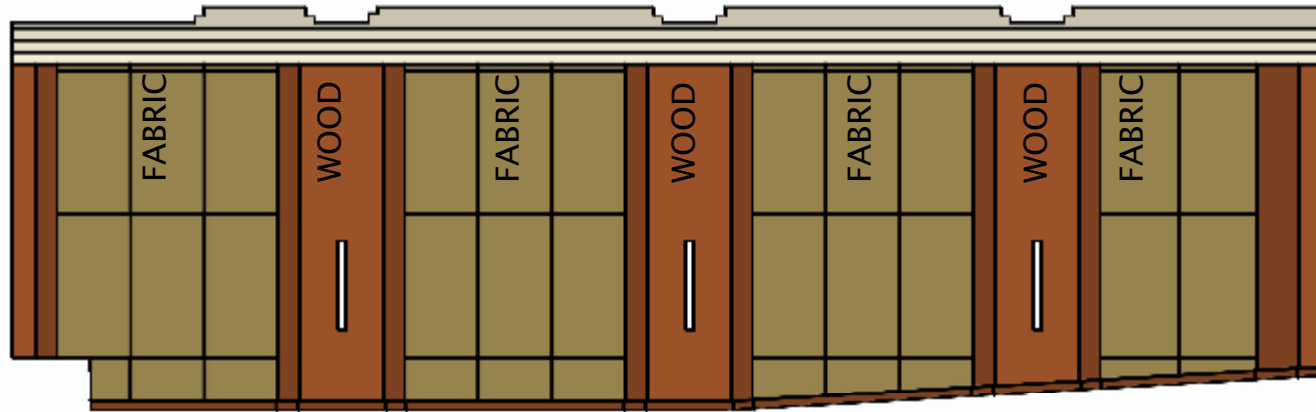

SIDE WALLS

Acoustical wood and acoustical fabric panels

Art-Deco geometry accentuating the existing

Accent lighting



ACOUSTICAL WOOD

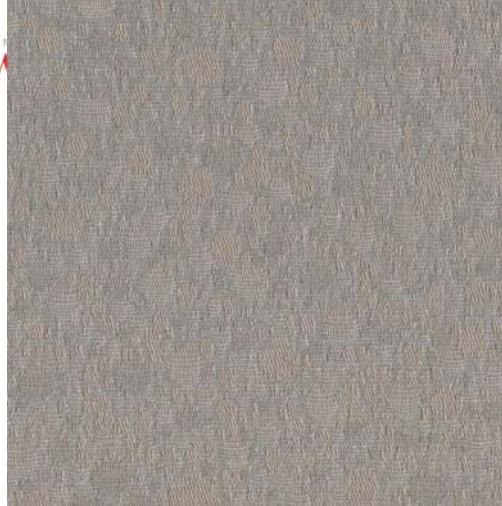

FABRIC PANELS



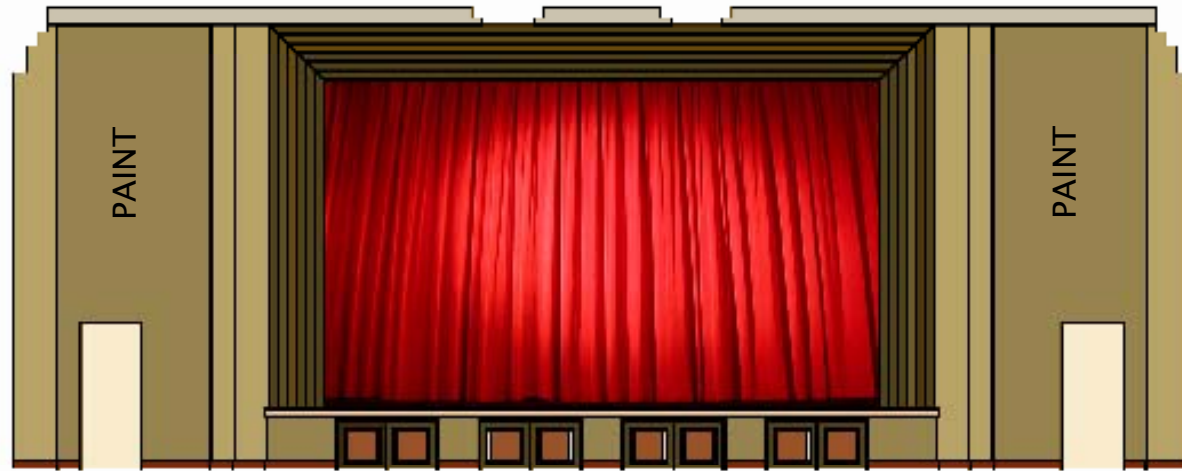

FRONT WALL ELEVATION

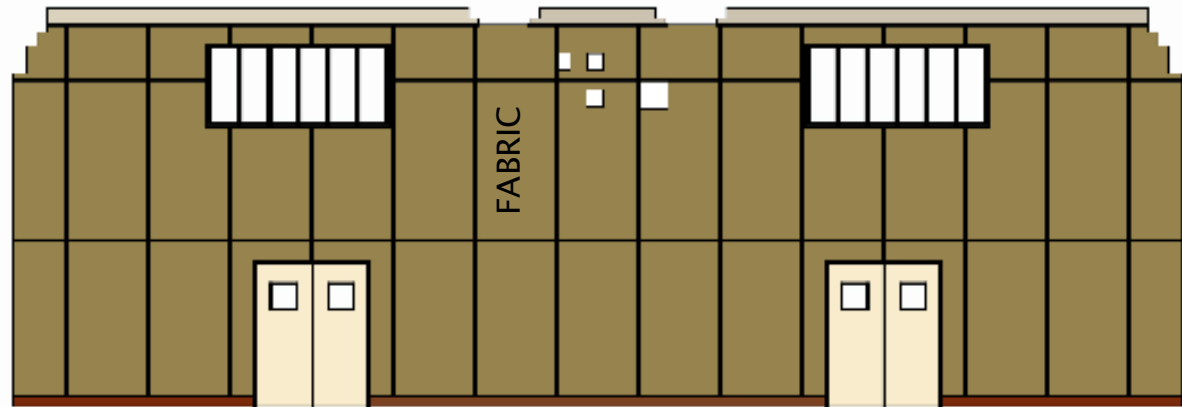

BACK WALL ELEVATION



SEATING

New stage curtains

Maintain historic appearance at the front wall

Stage extension

Back wall acoustic fabric panels

Maintain traditional projection room features

Provide new control room within the existing mezzanine



MASSING STUDY AT BUILDING EXTERIOR COURTYARD



MASSING STUDY AT BUILDING EXTERIOR

Newhall Auditorium Current Status

- ▶ Submitted for State Architect review and approval in April 2014
- ▶ Anticipated approval received by spring 2015
- ▶ Budget augmented by board in September 2013 by \$604,580 for upgraded equipment, lighting and stage expansion
- ▶ Fundraising efforts underway with the assistance of a contracted grant writer and headed by board members Christy Smith and Suzan Solomon

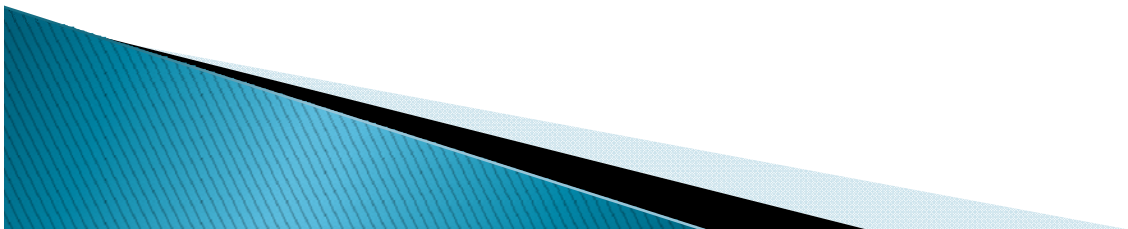









Meadows

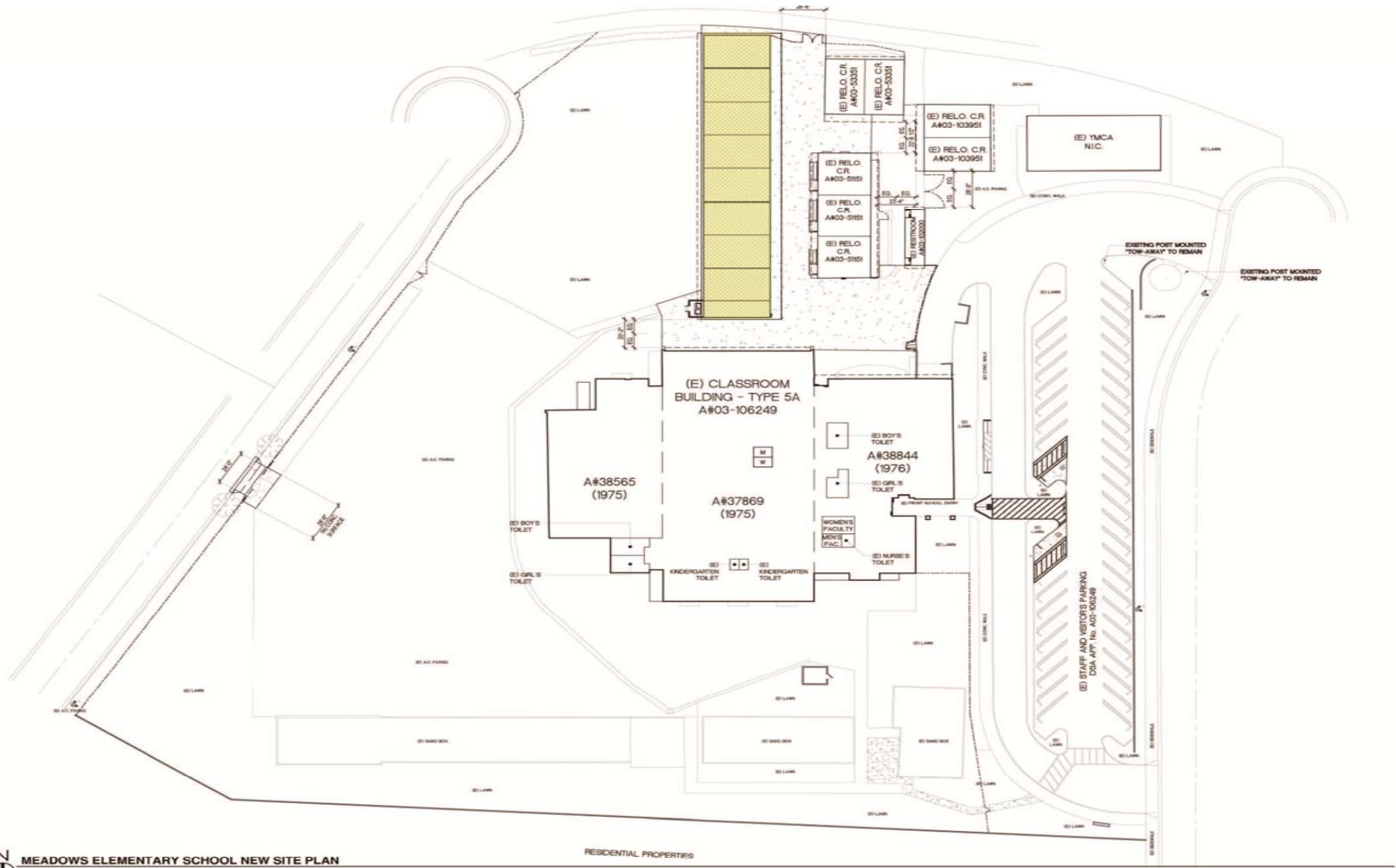





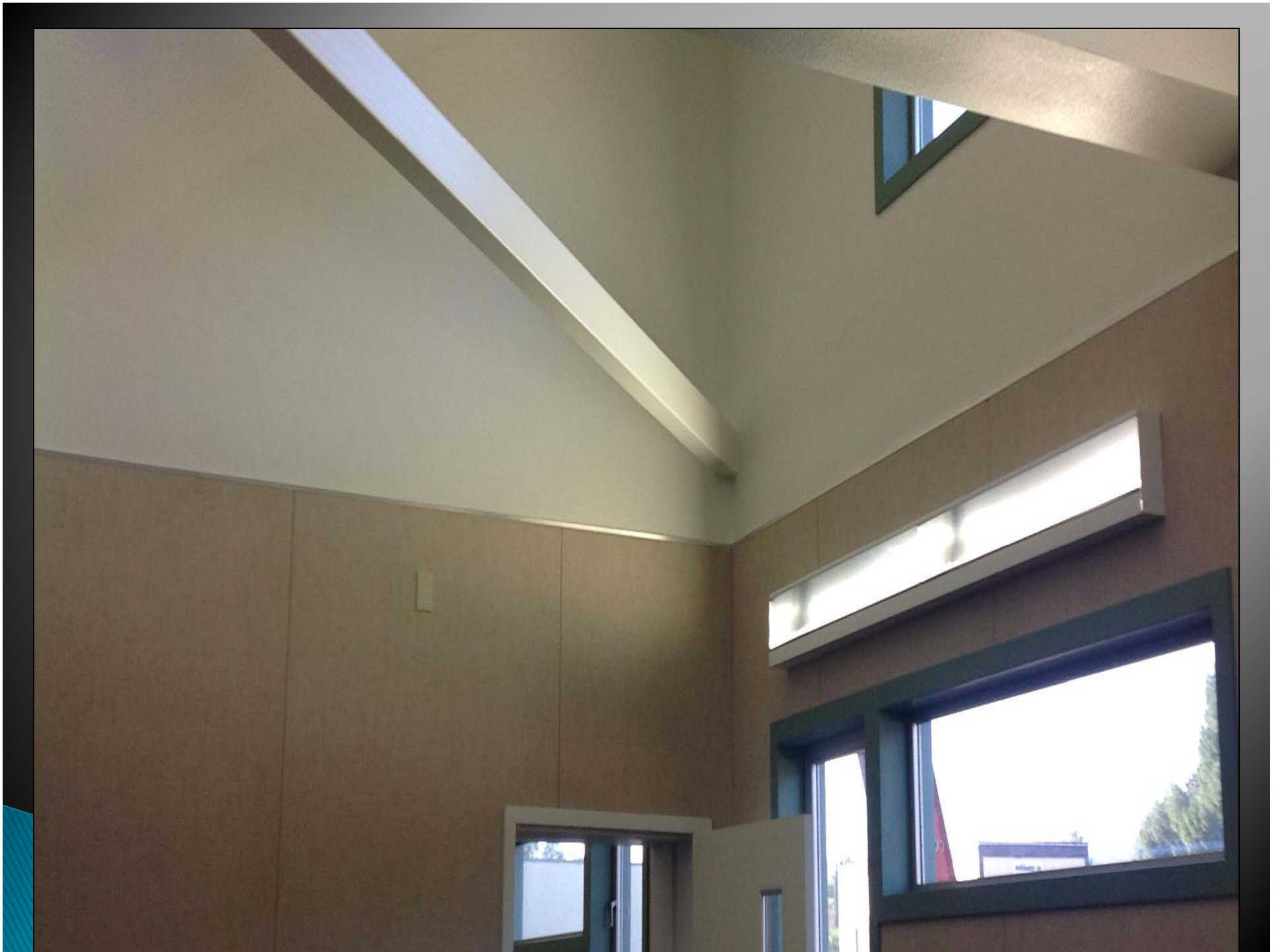





Newhall Elementary School





Newhall Elementary School



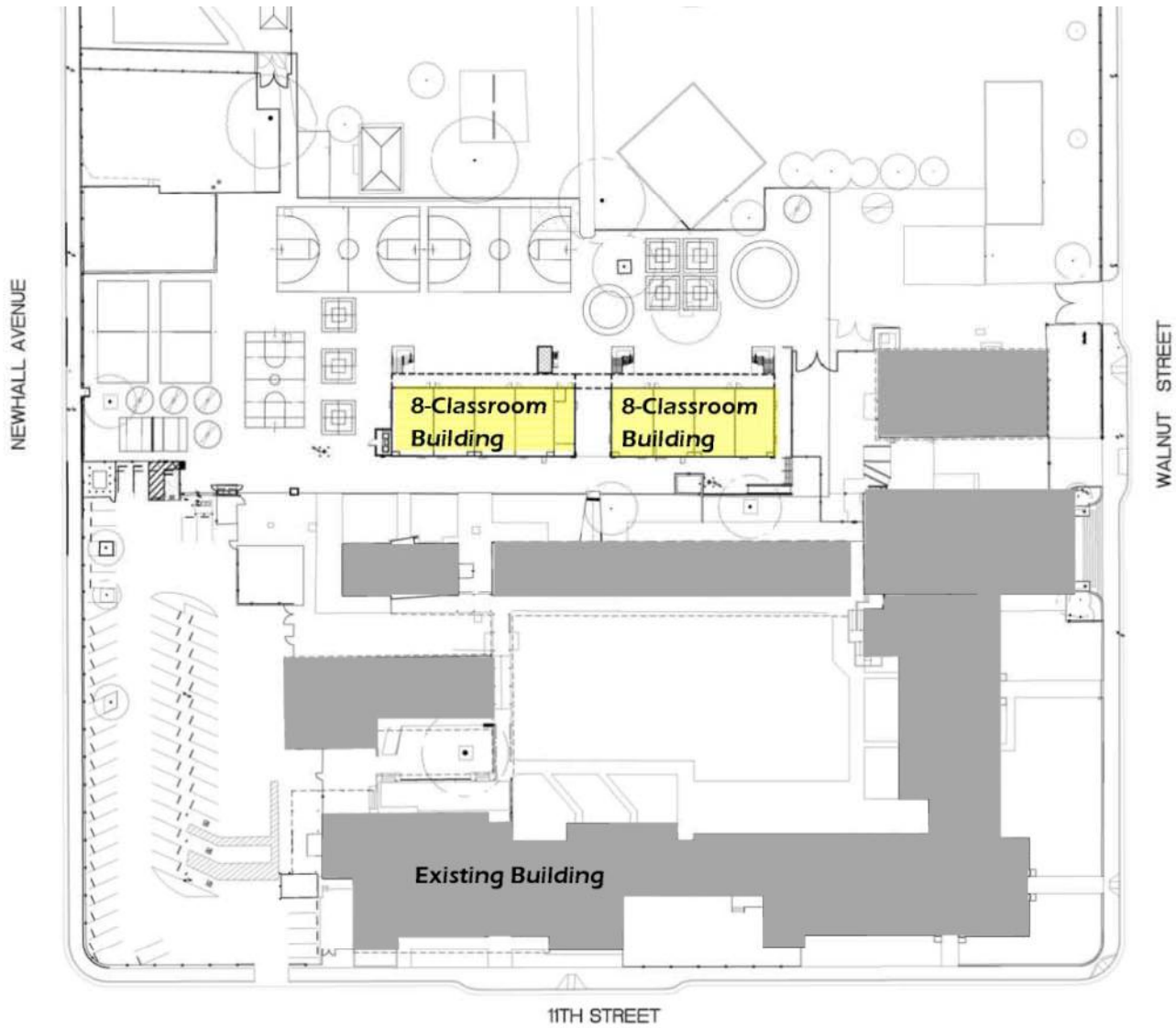

Newhall Elementary School



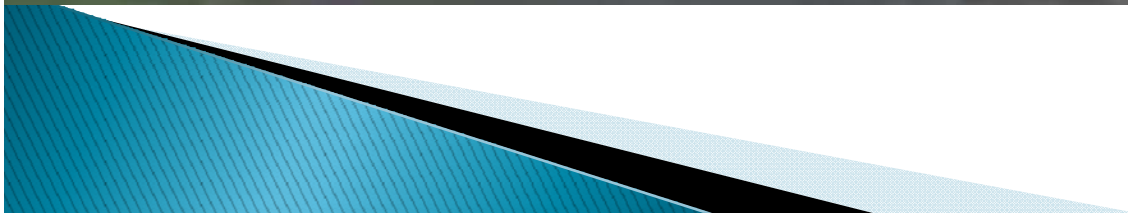



Newhall Classroom Status

- ▶ Final approval by State Architect received last week
- ▶ Anticipated board approval of construction contract November 2014
- ▶ Construction estimated to begin in late November 2014 and have buildings ready for occupancy by early fall 2015

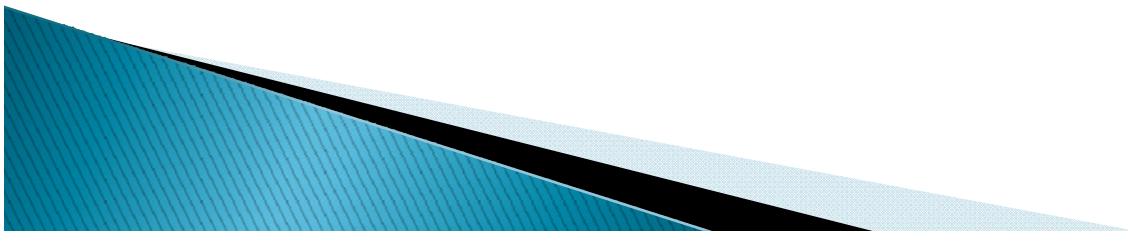

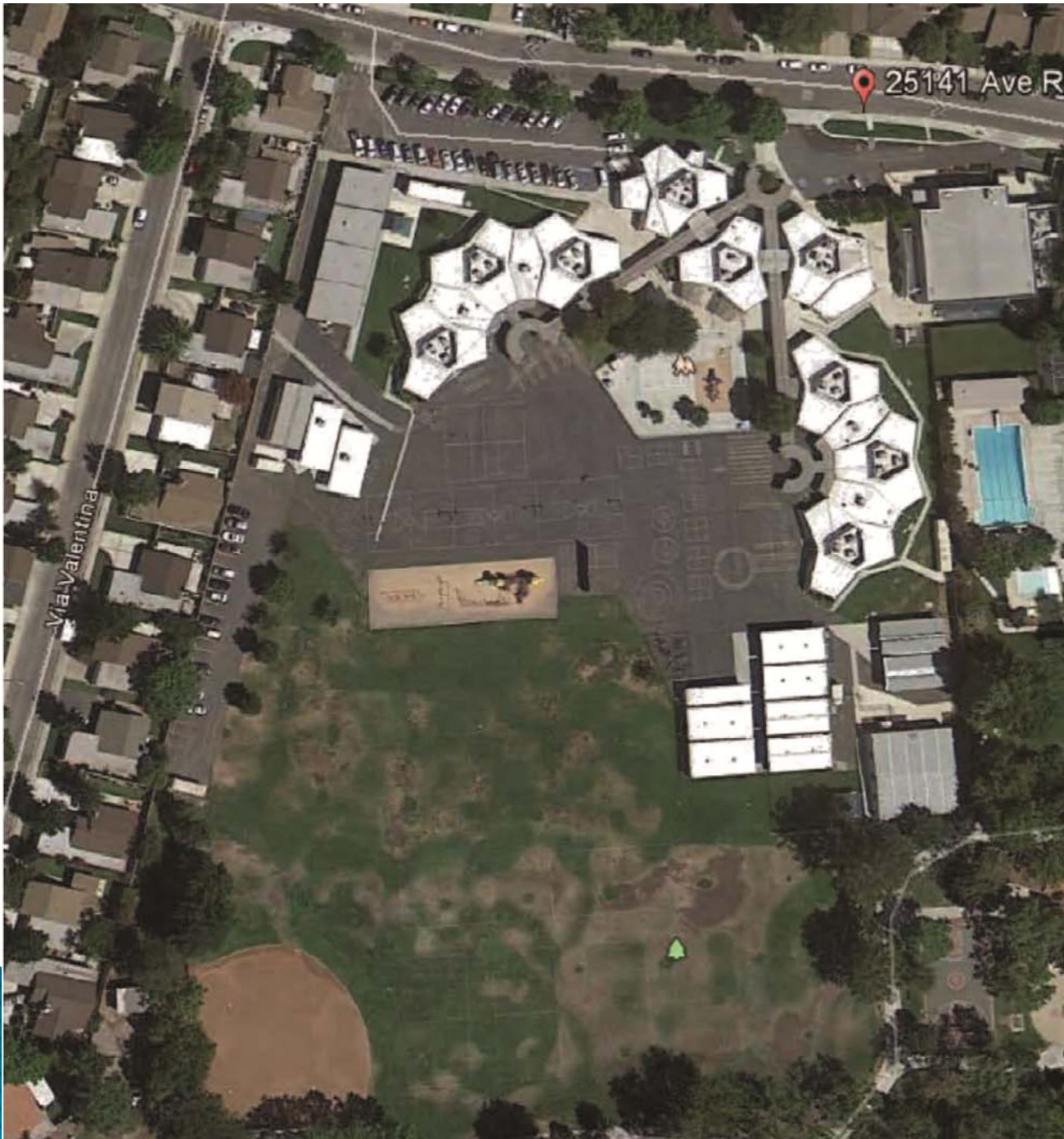

Old Orchard School

Schematic Design

September 17, 2013

NAC | ARCHITECTURE

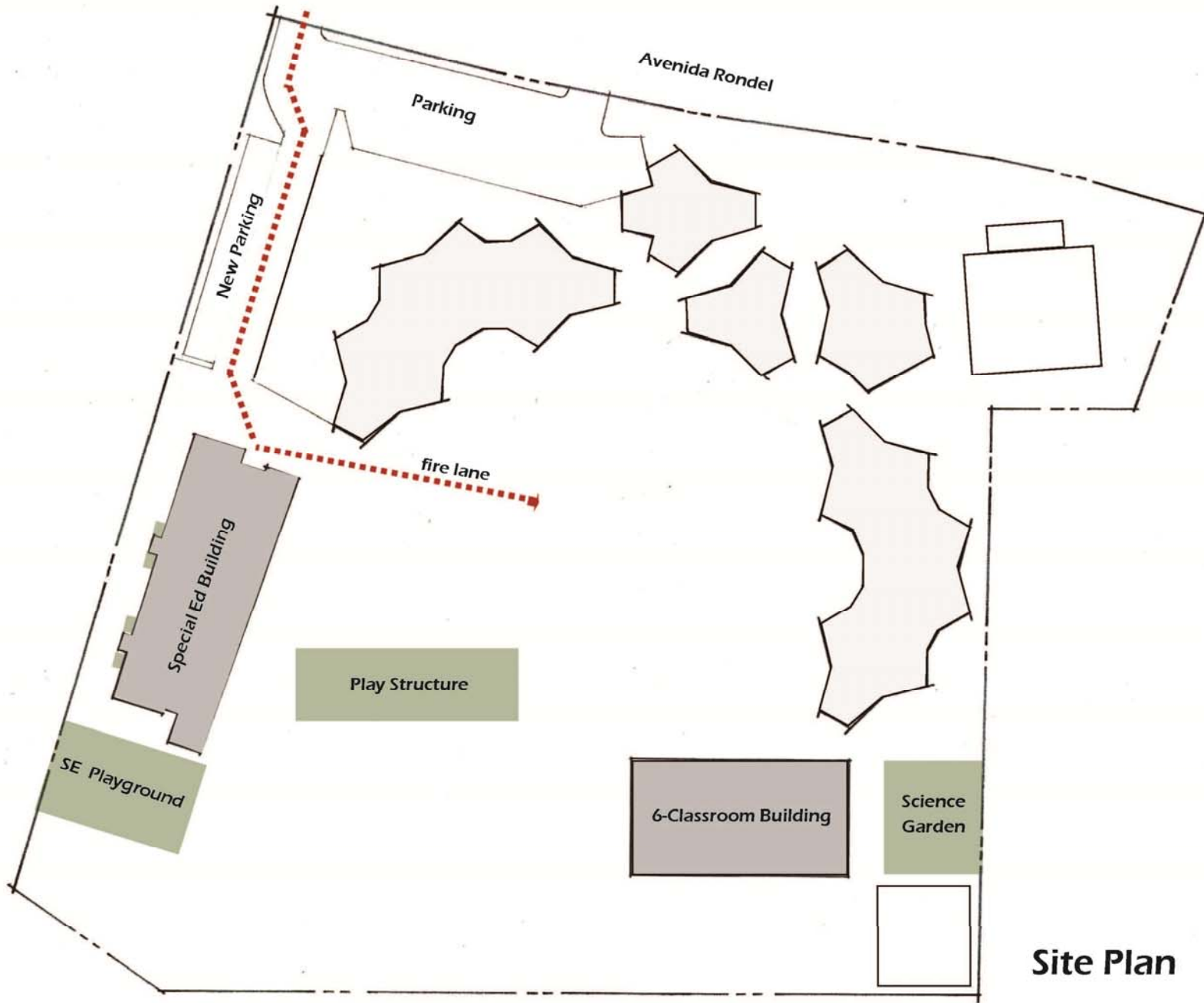

Site Plan

Old Orchard Status

- ▶ Design submitted to State Architect for review in February 2014
- ▶ Final approval anticipated by December 2014
- ▶ Construction estimated to begin in January 2015 and continue until September or October of 2015

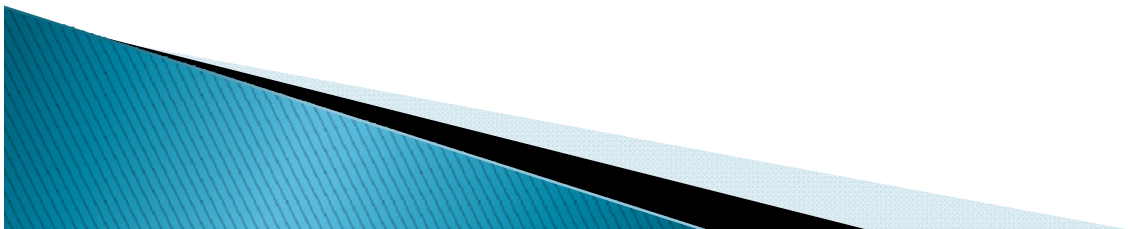



nsd
Newhall School District

Peachland E.S.

September 10, 2013

NAC | ARCHITECTURE

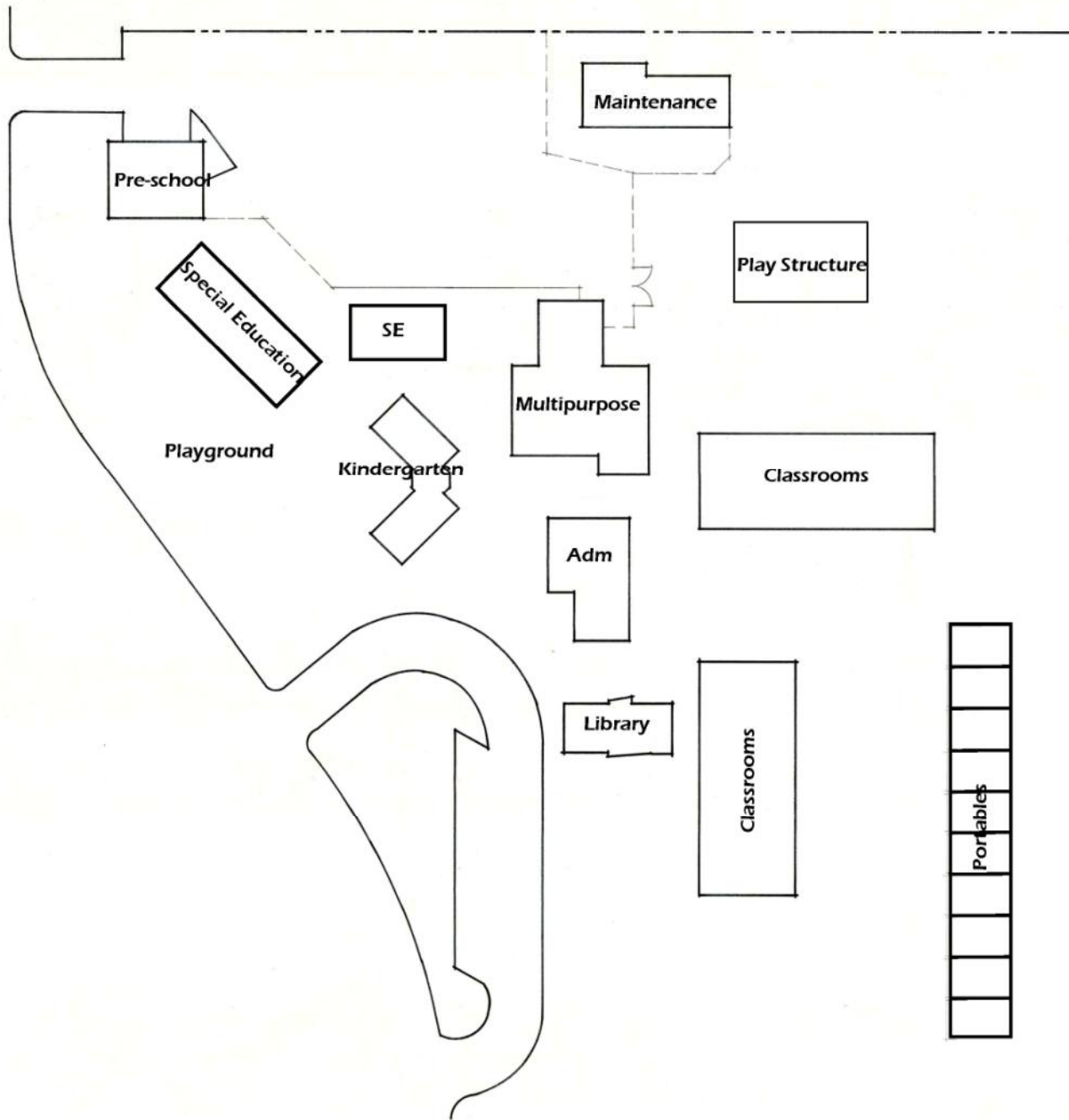

Legend

Existing:

14 Classrooms 0 Shared Spaces

4 Kindergarten

10 Portable Classrooms

Total 28 Classrooms

Special Education

1 PK1 Classrooms

1 Occupational Therapy

1 Psychologist | Speech Therapy

1 RSP | Psychologist

Existing Site

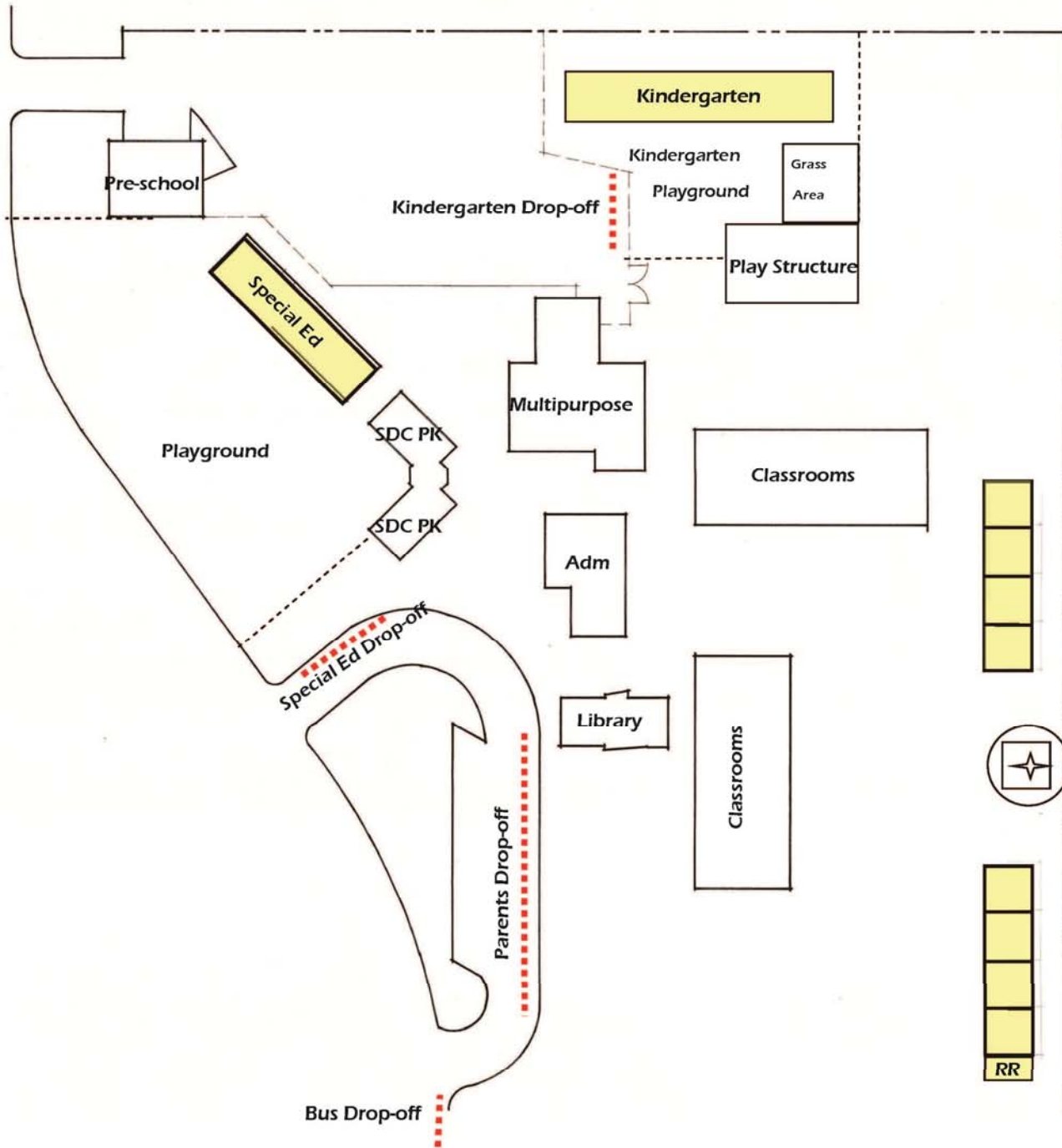

Legend

Existing:

- 14 Classrooms (permanent building)
- 10 Classrooms (portable building)
- 1 SDC K (permanent building)
- 1 TK (permanent building)
- 2 K (permanent building)
- 4 Special Ed CR + 1 Psych & Speech (portable building)
- Total of 32 Classrooms

Proposed:

- 16 Classrooms (permanent building)
- 8 Classrooms (new permanent building)
- 1 SDC K (new permanent building)
- 1 TK (new permanent building)
- 2 K (new permanent building)
- 2 Special Ed CR + 1 Psych & Speech (new permanent building)
- 2 Special Ed (relocate to permanent building)
- Total of 32 Classrooms



 Expansion/Renovation

Proposed Site

Peachland Status

- ▶ District has selected a modular manufacturer for the special ed and kindergarten buildings and design is underway
- ▶ The selection of the modular manufacturer for the upper grade classrooms is in progress
- ▶ Goal is to complete the design and submit to State Architect for review by December 31
- ▶ Estimated construction after final approval to begin in late May 2015

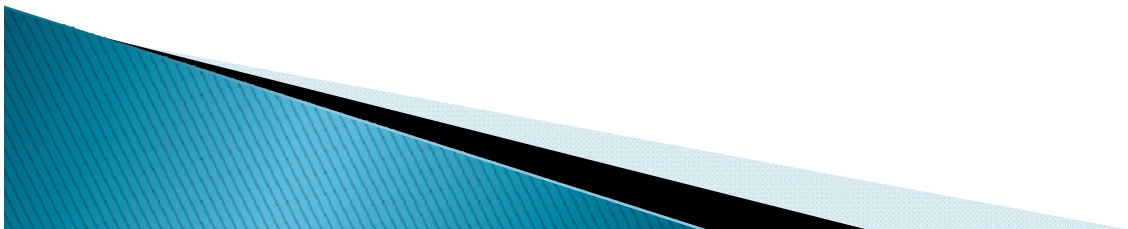

Technology Status

- ▶ Infrastructure complete including wireless and upgraded bandwidth capacity and internet speed
- ▶ Installation of Smart boards complete
- ▶ Implementation of 4:1 student to computer ratio almost complete
- ▶ Audio systems for classrooms complete
- ▶ Teacher computer and computer lab upgrades for Common Core state testing complete
- ▶ On-going technology training and support for students and teachers

**Thank you to all who supported
Measure E !**

